



CHERRY ORCHARD,
MARLBOROUGH

Carter Jonas

32 CHERRY ORCHARD, MARLBOROUGH, SN8 4AS

AMENITIES

- Sitting Room
- Kitchen
- Utility room
- Three bedrooms
- Two bathrooms
- Parking
- Garden
- Town location

SITUATION

Cherry Orchard is a short walk from the High Street, conveniently placed for all that Marlborough has to offer. Marlborough has an established reputation for both the practical and pleasurable necessities of life, with excellent shopping including national retailers such as Waitrose and Tesco supermarkets and several quality restaurants as well as boutique shops, cafes and pubs. Although self-sufficient the town is well placed for the larger centres of Bath, Newbury, Reading and Swindon and is surrounded by beautiful countryside including the Marlborough Downs, Pewsey Vale and Kennet Valley. There are several very good schools including St. John's Academy and the renowned Marlborough College.

DESCRIPTION

This newly refurbished home comprises of a spacious living room with lots of natural light, modern kitchen with built in oven and hob, fridge freezer and dishwasher, a utility room to the rear for white goods and offering access to the garden. The ground floor also benefits from a sleek and modern bathroom with shower over bath.

To the first floor there are two double bedrooms, the principal of which has an en-suite shower room. The third bedroom is a single room or could make an excellent office space. The property benefits from large windows throughout bringing in an abundance of natural light.

OUTSIDE

The rear garden is mainly laid to lawn and is fully enclosed. A paved area provides an area for seating. There is a driveway to the front of the house for one car and additional parking is on-street.

A NEWLY REFURBISHED THREE BEDROOM SEMI-DETACHED HOME WITH GARDEN AND DRIVEWAY PARKING WITHIN EASY REACH OF MARLBOROUGH TOWN CENTRE.



GUIDE PRICE: £375,000 (Subject to Contract)

VIEWING ARRANGEMENTS: By appointment with the Marlborough Office



Classification L2 - Business Data

Cherry Orchard, Marlborough, SN8
Approximate Area = 822 sq ft / 76.4 sq m

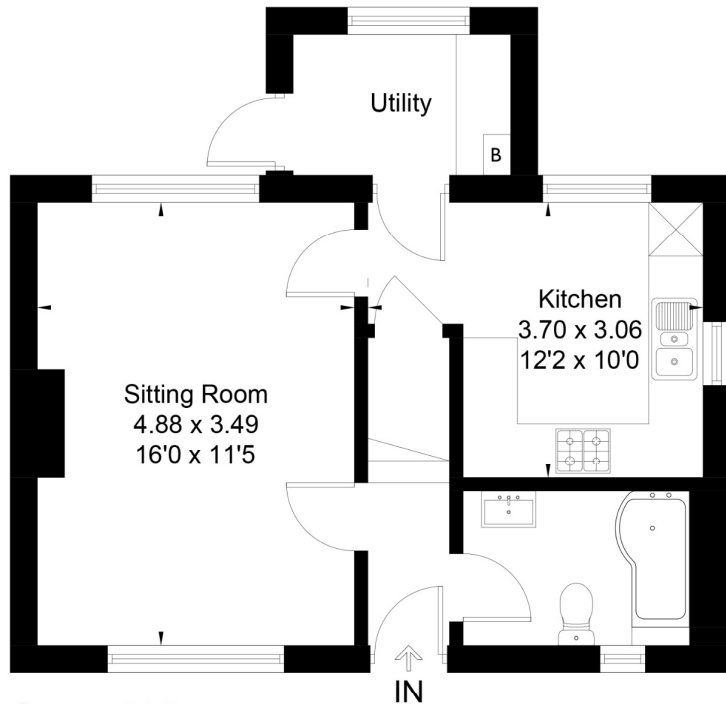

Ground Floor

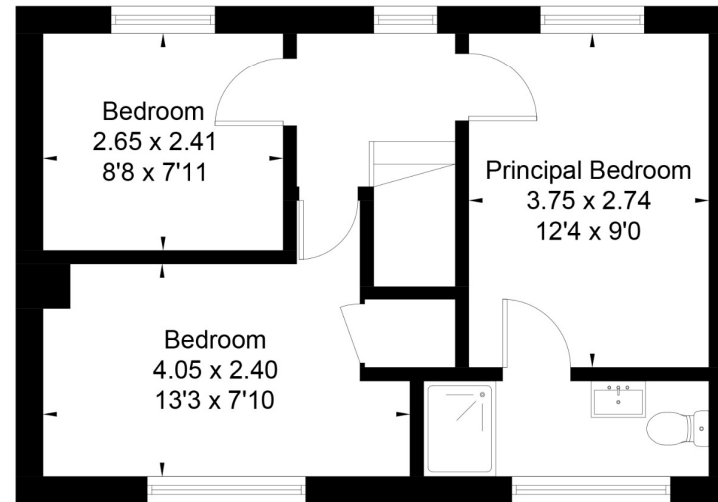

First Floor



This floor plan has been drawn in accordance with RICS Property Measurement 2nd edition.
All measurements, including the floor area, are approximate and for illustrative purposes only. @fourwalls-group.com #63693

SERVICES AND MATERIAL INFORMATION

- Freehold
- Mains water, mains drainage. Gas fired central heating.
- Council tax band: D
- Energy efficiency rating: C
- Broadband and mobile coverage. Please refer to Ofcom website

Marlborough 01672 514 916
93 High Street, Marlborough, SN8 1HD

carterjonas.co.uk
Offices throughout the UK

Exclusive UK affiliate of
CHRISTIE'S
INTERNATIONAL REAL ESTATE

IMPORTANT INFORMATION

These particulars are for general information purposes only and do not represent an offer or contract or part of one. Carter Jonas or anyone in their employment has made every attempt to ensure that the particulars and other information provided are as accurate as possible and they are not intended to amount to advice on which you should rely as being factually accurate. Full information which may be relevant to your decision regarding the property can be found on the property listing on carterjonas.co.uk or, (including off market properties) on the brochure or a separately available material information sheet. We would advise you to confirm the details of any material information prior to any offer being submitted. You should not assume that the property has all necessary planning, building regulations or other consents and Carter Jonas has not tested any services, facilities or equipment. Any measurements and distances given are approximate only. Where Carter Jonas has been provided with a floorplan by a third party, we cannot guarantee that the floorplan has been measured in accordance with IPMS. Purchasers must satisfy themselves of all of the aforementioned by independent inspection or otherwise. Our images only represent part of the property as it appeared at the time they were taken and do not represent the furnishings included; these are confirmed in a separate inventory. If you require further information, please contact us.

Classification L2 - Business Data