



PLOUGH LANE, LONDON, SW19
£600,000

Carter Jonas

PLOUGH LANE, LONDON, SW19

A three bedroom Edwardian freehold end of terrace home, in need of complete modernisation with the potential to extend from the existng 1151 sqft (stpp).

The property currently comprises 1151 sqft with two receptions, kitchen, dining room to the rear leading out to a good sized south facing garden.

The first floor has three bedrooms and a bathroom.

Plough Lane is less than 320m away from the transport links of Haydons Road. There is also easy access to the shops and restaurants in Wimbledon. Sole Agents. Chain free.

AMENITIES

- Unmodernised
- Three bedrooms
- Freehold
- Close to transport

TENURE Freehold

LOCAL AUTHORITY London borough of Merton

Southfields 020 7518 3260
sou.res.sales@carterjonas.co.uk
24 Replingham Road, London, SW18 5LR

carterjonas.co.uk
Offices throughout the UK

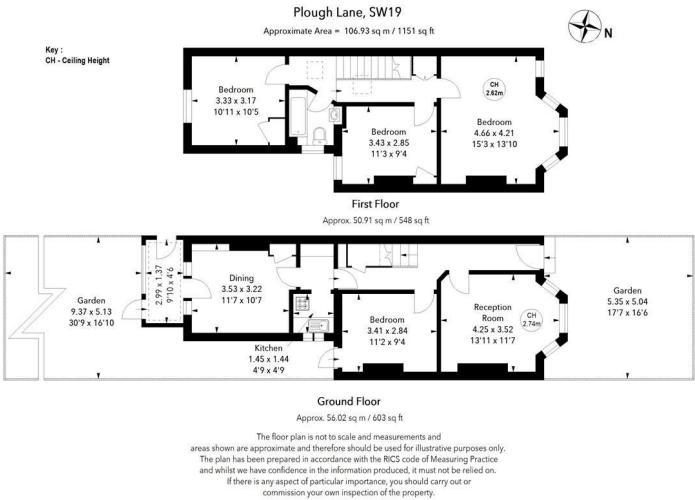

IMPORTANT INFORMATION

These particulars are for general information purposes only and do not represent an offer or contract or part of one. Carter Jonas or anyone in their employment has made every attempt to ensure that the particulars and other information provided are as accurate as possible and they are not intended to amount to advice on which you should rely as being factually accurate. Full information which may be relevant to your decision regarding the property can be found on the property listing on carterjonas.co.uk or, (including off market properties) on the brochure or a separately available material information sheet. We would advise you to confirm the details of any material information prior to any offer being submitted. You should not assume that the property has all necessary planning, building regulations or other consents and Carter Jonas has not tested any services, facilities or equipment. Any measurements and distances given are approximate only. Where Carter Jonas has been provided with a floorplan by a third party, we cannot guarantee that the floorplan has been measured in accordance with IPMS. Purchasers must satisfy themselves of all of the aforementioned by independent inspection or otherwise. Our images only represent part of the property as it appeared at the time they were taken and do not represent the furnishings included; these are confirmed in a separate inventory. If you require further information, please contact us.

Exclusive UK affiliate of
CHRISTIE'S
INTERNATIONAL REAL ESTATE
Classification L2 - Business Data