



KIRKDALE MANOR, HIGHFIELD LANE, NAWTON
Offers Over £360,000

Carter Jonas

HIGHFIELD LANE, NAWTON, YO62 7TL

Nestled within the exclusive gated community of Kirkdale Manor, this exquisite three-bedroom cottage unveils tranquillity and luxury that is truly a rare find. Converted from a stately manor house and its surrounding grounds in 2006, this development offers an unparalleled living experience. Residents are granted privileged access to the impeccably maintained communal gardens and a private tennis court, fostering a harmonious blend of community and seclusion.

This stunning cottage has been crafted to the highest standards, boasting a bespoke fitted kitchen adorned with quartz worktops and Rangemaster cooker. Oak and stone floors grace the interior, complemented by the warmth of underfloor heating. The living room, features solid oak floors and a cozy fireplace with a quality log-burning stove, inviting you to relax in utmost comfort. Beyond the double doors lies the kitchen and dining area, where large windows overlook the rear gardens.

Upstairs, there are three generously proportioned bedrooms, with the master suite boasting an en-suite shower room and ample fitted wardrobes. A family bathroom with a bath, shower, and heated towel rail caters to the other residents or guests. Outside, a garden awaits, with landscaped flowerbeds, mature fruit trees, and a delightful patio area perfect for al fresco dining. Crowning this idyllic oasis is a bespoke cedar-clad garden studio or home office, equipped with high-speed broadband, providing the ultimate sanctuary for remote work or creative pursuits.

With a separate garage and two designated parking spots (one space outside the property, the other under a carport opposite), this property offers unparalleled convenience and charm.

Tenure - Leasehold

Service charge - £1,531.37

Lease length - 999 years from 1st Jan 2021.

This property is connected to a mains electricity supply. The central heating is Bio Mass.

- The water and drainage are supplied by Yorkshire Water.
- Broadband is fibre. For speed - please go to checker.ofcom.org.uk/en-gb/broadband-coverage
- Mobile coverage - please go to checker.ofcom.org.uk/

LOCAL AUTHORITY North Yorkshire Council
confirmed **COUNCIL TAX BAND** E

EPC BAND To be

STUNNING 3-BED COTTAGE WITH OAK FLOORS, UNDERFLOOR HEATING, QUALITY KITCHEN, LANDSCAPED GARDENS, AND CEDAR HOME OFFICE/STUDIO.





Classification L2 - Business Data



Classification L2 - Business Data

GROUND FLOOR
693 sq.ft. (64.4 sq.m.) approx.

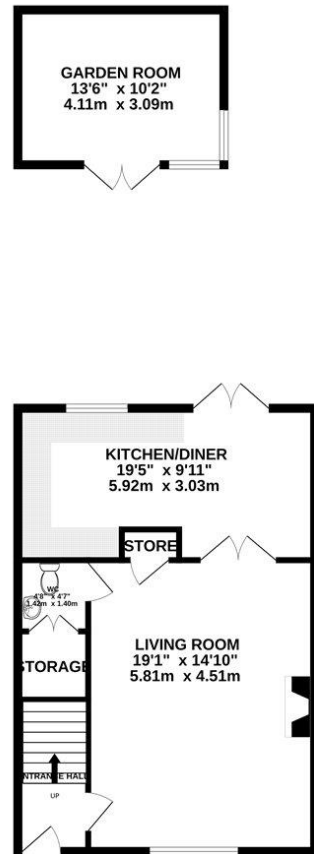

1ST FLOOR
563 sq.ft. (52.3 sq.m.) approx.

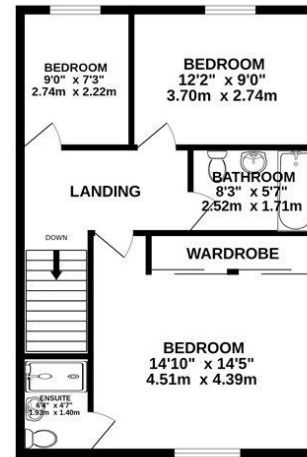

TOTAL FLOOR AREA: 1256 sq.ft. (116.7 sq.m.) approx.

Whilst every attempt has been made to ensure the accuracy of the floorplan contained here, measurements of doors, windows, rooms and any other items are approximate and no responsibility is taken for any error, omission or mis-statement. This plan is for illustrative purposes only and should be used as such by any prospective purchaser. The services, systems and appliances shown have not been tested and no guarantee as to their operability or efficiency can be given.
Made with Metropix ©2024

York 01904 558200

york@carterjonas.co.uk
82 Micklegate, York, YO1 6LF

carterjonas.co.uk
Offices throughout the UK

IMPORTANT INFORMATION

These particulars are for general information purposes only and do not represent an offer of contract or part of one. Carter Jonas has made every attempt to ensure that the particulars and other information provided are as accurate as possible and are not intended to amount to advice on which you should rely as being factually accurate. You should not assume that the property has all necessary planning, building regulations or other consents and Carter Jonas have not tested any services, facilities or equipment. Any measurements and distances given are approximate only. Purchasers must satisfy themselves of all of the aforementioned by independent inspection or otherwise. Although we make reasonable efforts to update our information, neither Carter Jonas LLP nor anyone in its employment or acting on its behalf makes any representations warranties or guarantees, whether express or implied, in relation to the property, or that the content in these particulars is accurate, complete or up to date. Our images only represent part of the property as it appeared at the time they were taken. If you require further information please contact us.

Classification L2 - Business Data